

Submersible drainage pumps for clear water and drainage water.

H 106, H 117

Application

HOMA H 106 and H 117 are submersible drainage pumps. With their 10 mm spherical clearance they are the ideal solution to pump water from basements cellars sumps and collection tanks. Also suitable for pumping discharge from hand basins, showers and washing machines, for flood relief and water removal from water courses or reservoirs.

DIN EN 12050-2: Conformity and design approved and controlled by LGA, certificate No. 0220119.

Installation: Transportable or permanent. Models with float switch control for automatic pump operation, depending on medium level in the sump.

Pumped medium: Clear water or drainage water containing soft solids up to 10 mm spherical clearance.

Max. medium temperature: 35° C, short term up to 60° C.

Operation: Intermittent.

Design

Fully submersible, compact integrated motor-pump unit consisting of:

Pump: Single stage centrifugal pump with horizontal discharge.

Impeller: Open multi-channel impeller, spherical clearance 10 mm.

Motor: Fully submersible, pressure tight electric motor, oil-filled. Insulation class B. Motor protection IP 68. Cable connection chamber totally isolated from motor housing.

Cable: H07RN-F 4 G 1,5

Model W: H07RN-F 3 G 1

Shaft/Bearing: Large diameter stainless steel rotor shaft, pre-lubricated bearings.

Seals: Triple lip-seal combination.

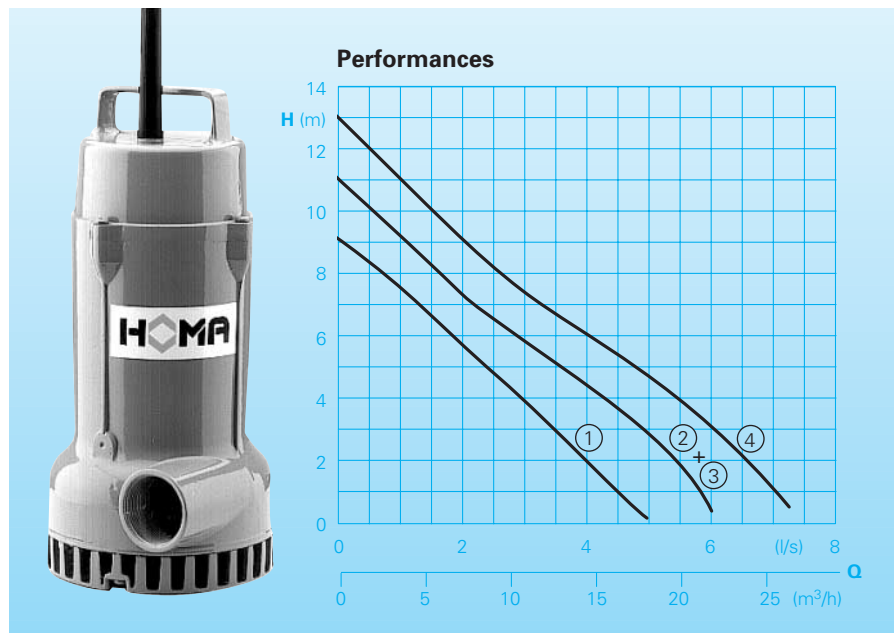

Technical Data

Curve No.	Pump type	Motor-input P ₁ (kW)	Motor-output P ₂ (kW)	Voltage 50 Hz (V)	Nominal current (A)	Discharge	Weight (kg)
①	H 106 W (A)	0,65	0,5	230-240/1Ph	4,0	BSP 1¼" F	10,5
②	H 106 D (A)	0,65	0,5	400-415/3Ph	1,7	BSP 1¼" F	11,0
③	H 117 W (A)	0,85	0,6	230-240/1Ph	5,5	BSP 1½" F	12,0
④	H 117 D (A)	1,1	0,9	400-415/3Ph	2,1	BSP 1½" F	13,5

Speed: 2900 rpm

Model A: With automatic level control HOMA-Nivomatik

Materials:

Motor housing, pump housing, impeller	Aluminium
Rotor shaft, screws	Stainless steel
Elastomere	Perbonane

Model D: (400-415V/3Ph): Supplied with control box fitted with overload protection, on-off-switch and 10 m of cable.

Model A: With additional automatic level control, AS-float switch, manual-auto-switch, 5 m of cable.

Equipment supplied

Model W (230-240V/1Ph): Supplied with control box fitted with overload protection, on-off-switch and 10 m of cable.

Dimensions and Installations

H 106

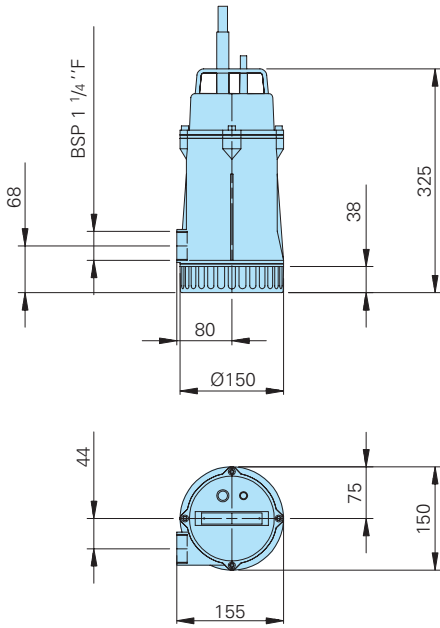

all dimensions in mm

H 117

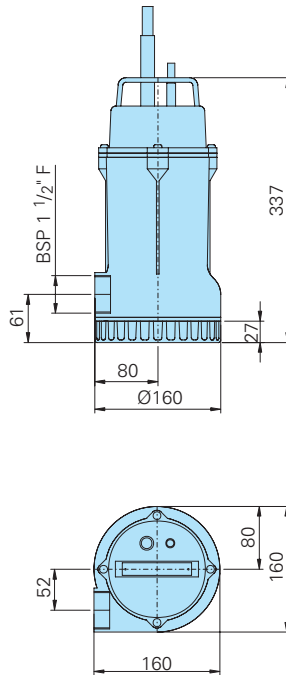

Wet well installation with pipework, level control and control box.

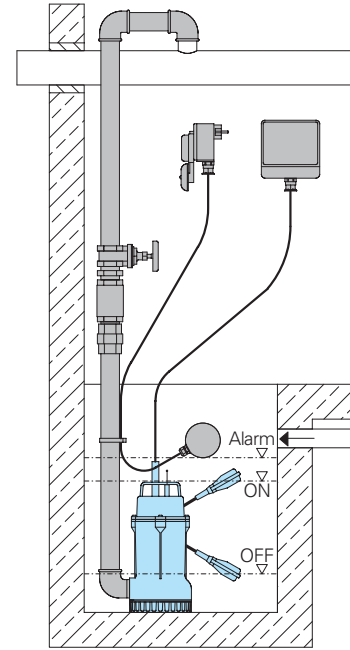

Accessories

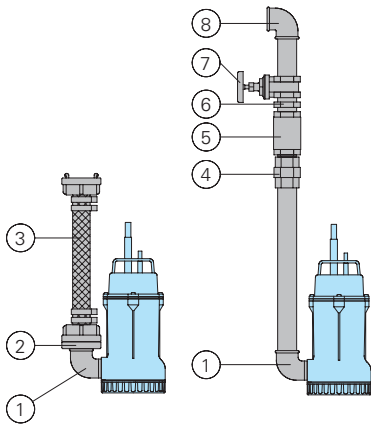

Part Descriptions	Dimension	Part No.	Part Descriptions	Dimension	Part No.
① 90° elbow, galvanized	BSP 1 1/4" F/M	2111405	○ HOMA-Nivomatik float switch level control conversion kit		
	BSP 1 1/2" F/M	2111505			
② Brass fixed coupling	BSP 1 1/4" M	2005413	- for 230-240 V/1Ph		
	BSP 1 1/2" M	2005513	AZW 10/5	length 5 m	1435055
Brass STA-hose coupling	BSP 1 1/4" M	2001413	AZW 10/10	length 10 m	1435105
	BSP 1 1/2" M	2001513	- for 400-415 V/3Ph		
STORZ-fixed coupling	C-BSP 1 1/2" M	2010003	AZD 10/5	length 5 m	1912452
③ PVC-hose per m	1 1/4" dia.	2621200	AZD 10/10	length 10 m	1914452
	1 1/2" dia.	2621500			
Reinforced hose, per m	1 1/4" dia.	2632030	○ Alarm device AL 1		1586010
	1 1/2" dia.	2632038	Mains-operated with connector for battery 9V (see below) for mains-independent operation with integrated buzzer.		
Brass hose coupling	1 1/4" dia.	2003413	Mains connection 220-240 V/1Ph		
	1 1/2" dia.	2003513	Battery for mains-independent operation	9V	1952209
STORZ hose coupling	C-38 dia.	2013002	Float switch MB, mercury free, on or off, with integrated counter weight cable length		
Hose band	1 1/4"	2303252	- 6 m	1465706	
	1 1/2"	2304854	- 10 m	1465710	
④ Galvanized pipe union	BSP 1 1/4" M/F	2114304	○ HOMA 2 poles earth leakage circuit breaker, Fi 16/0,03A		1561160
	BSP 1 1/2" M/F	2114305			
⑤ Bronze non-return valve	BSP 1 1/4" F	2211213	○ Control panels for single or twin pump station for automatic operation		On request
	BSP 1 1/2" F	2211313			
⑥ Galvanized double nipple	BSP 1 1/4" M	2009011			
	BSP 1 1/2" M	2009020			
⑦ Bronze gate valve	BSP 1 1/4" F	2216012			
	BSP 1 1/2" F	2216015			
⑧ 90° galvanized elbow	BSP 1 1/4" F	2113604			
	BSP 1 1/2" F	2113605			
T-piece for twin-pump arrangement	BSP 1 1/4" F	2114301			
	BSP 1 1/2" F	2114302			

HOMA
P U M P T E C H N O L O G Y

HOMA Pumpenfabrik GmbH
P.O.Box 22 63, D-53814 Neunk.-Seelscheid
Tel. ++49(0)22 47/702-0, Fax ++49(0)22 47/402-44
e-mail: info@homa-pumpen.de
www.homapumps.com