

Jacket cooled submersible drainage pumps with integrated float switch for clear water and drainage water

Chromatic® C 239 WE

Application

For irrigation and drainage in clear or drainage water. Cellar drainage, pumping water from sumps, pits and rooms. Also suitable for pumping discharge from hand basins, showers and washing machines, for flood relief and water removal from water courses or reservoirs.

The water jacket cooled motor with the top discharge protects the motor against overheating even during sip operation. The integrated float switch with its extremely compact design allows an application in very narrow sumps.

Installation: Permanent or transportable.

Pumped medium: Clear water or drainage water containing soft solids. Max. medium temperature: 35°C, short term up to 60°C.

Operation: Intermittent.

Design

Fully submersible drainage pump consisting of:

Pump: Single stage centrifugal pump with vertical discharge BSP 1 1/4".

Discharge connection with integrated non-return valve.

Impeller: Open multi-channel impeller, spherical clearance 10 mm.

Motor: Fully submersible, pressure tight electric motor. Stainless steel motor housing. Insulation class B. Motor protection IP 68. Thermal sensors imbedded in the motor winding.

Shaft/bearing: Large diameter stainless steel rotor shaft, pre-lubricated bearings.

Seals: Triple lip-seal combination.

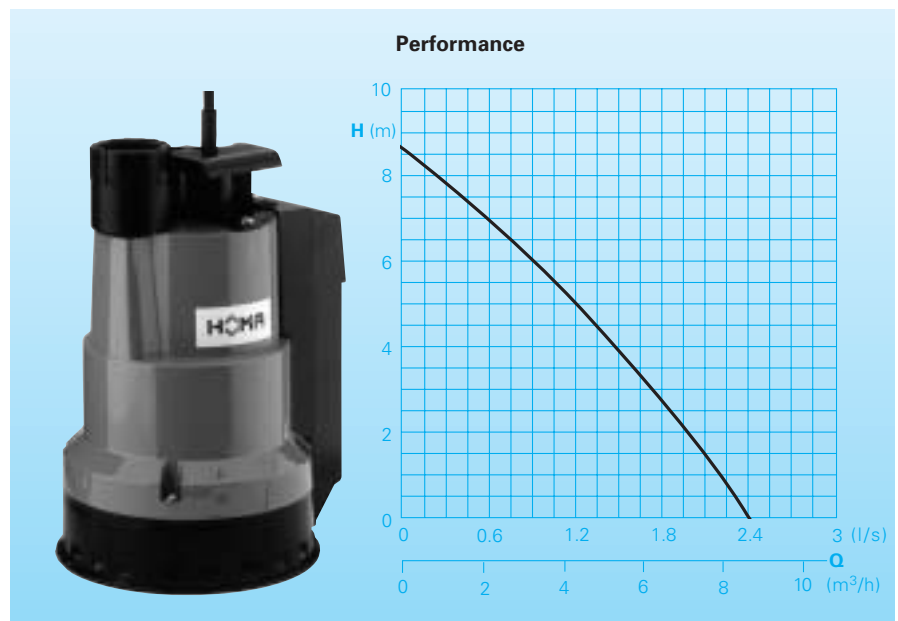

Technical Data

Pump type	Motor-input P1 (kW)	Motor-output P2 (kW)	Voltage 50 Hz (V)	Nominal current (A)	Cable type	Weight (kg)
C 239 WE	0,4	0,2	230 / 1Ph	2,0	H05RN-F3G0,75	4,7

Speed: 2900 rpm

Discharge: BSP 1 1/4"

Materials:

Motor housing, rotor shaft, screws	Stainless steel
Suction sieve, Pump housing	Wear resistant synthetic material (composite)
Impeller	Glass-fibre, reinforced synthetic material (composite)
Elastomere	NBR

Equipment supplied

Pump with discharge connection BSP 1 1/4" F with integrated non-return valve. 10 m of cable and plug.

**Wet well installation
with pipework and control box**

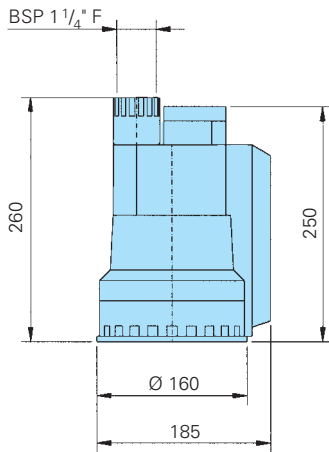

Dimensions in mm

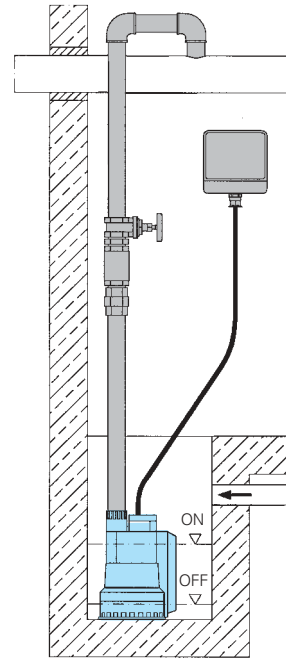

Accessories

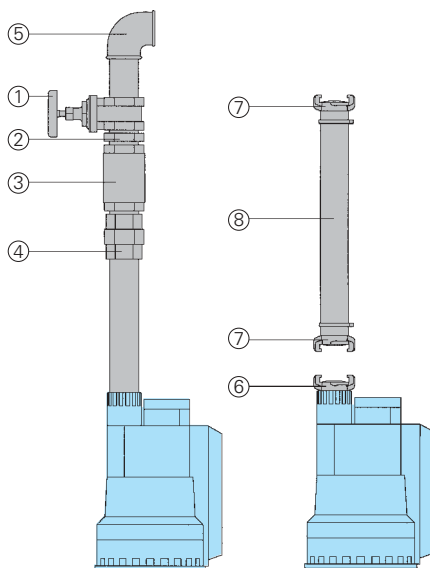

Part Description	Dimension	Part. No.	Part Description	Dimension	Part. No.
① Bronze gate valve	BSP 1 1/4" F	2216012	○ HOMA 2 poles earth leakage circuit breaker Fi 16/0,03 A		1561160
② Galvanized double nipple	BSP 1 1/4" M	2009011	○ Alarm device AL 1 Mains operated with connector for battery 9V (see below) for mains independent operation with integrated buzzer. Mains connection 220-240 V/ 1 ph		1586010
③ Bronze non-return valve (if integrated non-return valve is not fitted)	BSP 1 1/4" F	2211213	Battery for mains-independent operation	9 V	1952209
④ Galvanized pipe union	BSP 1 1/4" M/F	2114304	Float switch MB, mercury free, on or off, with integrated counter weight. Cable length	6 m 10 m	1465706 1465710
⑤ 90° galvanized elbow	BSP 1 1/4" F BSP 1 1/4" F/M	2113604 2111405	○ Control panel for single or twin pump station for automatic operation		On request
T-piece for twin pump arrangement	BSP 1 1/4" F	2114301			
⑥ Brass fixed coupling	BSP 1 1/4" M	2005413			
⑦ Brass hose coupling	BSP 1" BSP 1 1/4"	2003313 2003413			
⑧ PVC hose, per m	1" Ø 1 1/4" Ø	2621000 2621200			
Reinforced hose, per m	1" Ø 1 1/4" Ø	2632025 2632030			
Hose band	3/4" - 1" 1 1/4"	2302330 2303252			



HOMA Pumpenfabrik GmbH
 P. O. Box 22 63, D-53814 Neunk.-Seelscheid
 Tel. ++49(0)22 47/702-0, Fax ++49(0)22 47/702-44
 e-mail: info@homa-pumpen.de
 www.homapumps.com